

96W Triac Dimmable 100-277VAC Constant Voltage LED Driver + PWM Signal Output ITEM #5030-PSU-96W24V-TRI-DIM-CL2



FEATURES

- Output constant voltage
- Input voltage range 100-277VAC
- Built-in PFC function, PF> 0.98
- Efficiency > 82% / Dimming range: 0~100%
- Protections:short circuit/over voltage/over heat
- IP20 design for indoor installations
- Cooling by free air convection / Flicker-free
- Work with leading edge and trailing edge TRIAC dimmers
- Strong compatibility, flicker-free dimming
- Suitable for LED lighting and moving sign applications
- Compliance to worldwide safety regulations for lightings.
- Compatible with Forward phase, Reverse phase, Triac, MLV, ELV Dimmers
- 7 years warranty
- UL/cUL listed, Class P, Type HL approval
- Also available in Multi-Class2 outputs (2 and 3 outputs)



Specification

Class 2 Class P Type HL CE IP67

model		5030-PSU-96W24V-TRI-DIM-CL2
Output	DC Voltage	24V
	Voltage Accuracy	±0.5V
	Rated current	4.0A
	Rated power	96W
Input	Voltage Range	100~277V AC
	Frequency Range	47~63HZ
	Power Factor (Typ.)	PF ≥ 0.95/110V, PF ≥ 0.97/277V
	Full Load Efficiency(Typ.)	>82%
	AC Current (Typ.)	1.33A/110VAC
	Inrush Current (Typ.)	20A, 50%, 1.6ms
	Leakage current	< 0.5mA/110V
Protection	Short Circuit	Hiccup mode, recovers automatically after fault condition is removed.
	Over temperature	100°C±10°C shut down o/p voltage, automatically recover after cooling.
	Over Loading	≤120% constant current limiting, auto-recovery
	Over voltage	≤ 140VAC(90~135V) , ≤ 270VAC(170~265V)
Environment	Working TEMP.	-40~+60°C
	Working Humidity	20~90%RH,non-condensing
	Storage TEM.,Humidity	-40~+80°C , 10~95%RH
	TEMP.coefficient	±0.03%/°C (0~50°C)
	Vibration	10~500Hz, 2G 10min./1 cycle, period for 60min. each along X,Y,Z axes
Safety&EMC	Safety standards	UL8750+UL1310
	Withstand voltage	I/P-O/P:3.75KVAC
	Isolation resistance	I/P-O/P: 100MΩ/500VDC/25°C/70%RH
	EMC EMISSION	FCC Part 15 B

	EMC IMMUNITY	Compliance to EN55015; EN61000-4-2,3,4,5,6,8,11,EN61547 Alight industry level (surge4KV)
Others	Net Weight	1.1Kg
	Size	230*70*46mm (L*W*H)
	packing	329*279*176mm , 10PCS/ctn
Notes	1. All parameters NOT specially mentioned are measured at 110V/277VAC input , rated load and 25℃of ambient temperature.	
	2. Tolerance:includes set us tolerance,line regulation and load regulation .	

■ Mechanical Specification:

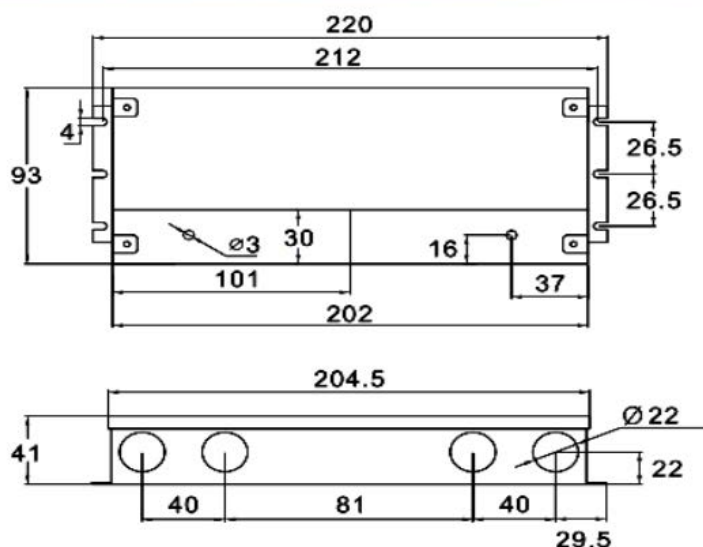

- ※ Input Rubber wire 3*18AWG Black and White to be connected to AC L and N ,Green wire go ground,
- ※Output Rubber wire, 2*16AWG Red to LED Positive side (+) , Black to LED Negative side (-).

■Dimming Operation

- 1) Output constant current level can be adjusted through input terminal of the AC phase line(L) by connection a triac dimmer.
- 2) The Pulse-Width Modulation (PWM) of output voltage can be adjusted by the input terminal of the AC phase line(L) by connection a phase/triac dimmer.
- 3) Compatible with triac dimmers, Forward phase, leading edge or Reverse phase, trailing edge ,Electric low voltage Dimmers.
- 4) please try to use the small power dimmers with power at least 1.5 times as the output power of the driver., which can be accessed to a wider dimming range, high-power dimmer is difficult to achieve the output current to zero.

■Derating Curve

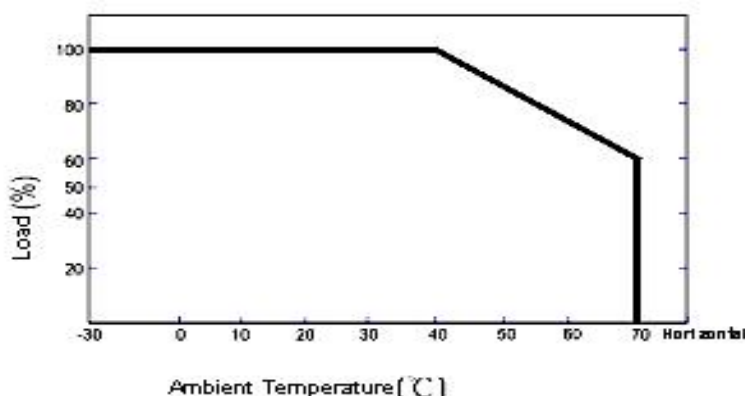

※Load carried in accordance with the load derating curve, according to the ambient temperature derating, in order to extend the working life.

■ Simple Connection Diagram

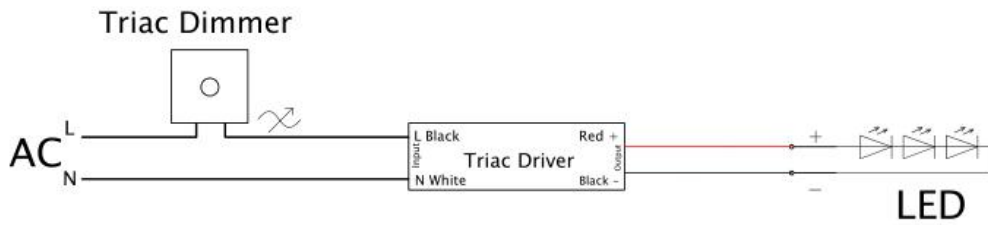

■ Connecting Diagram

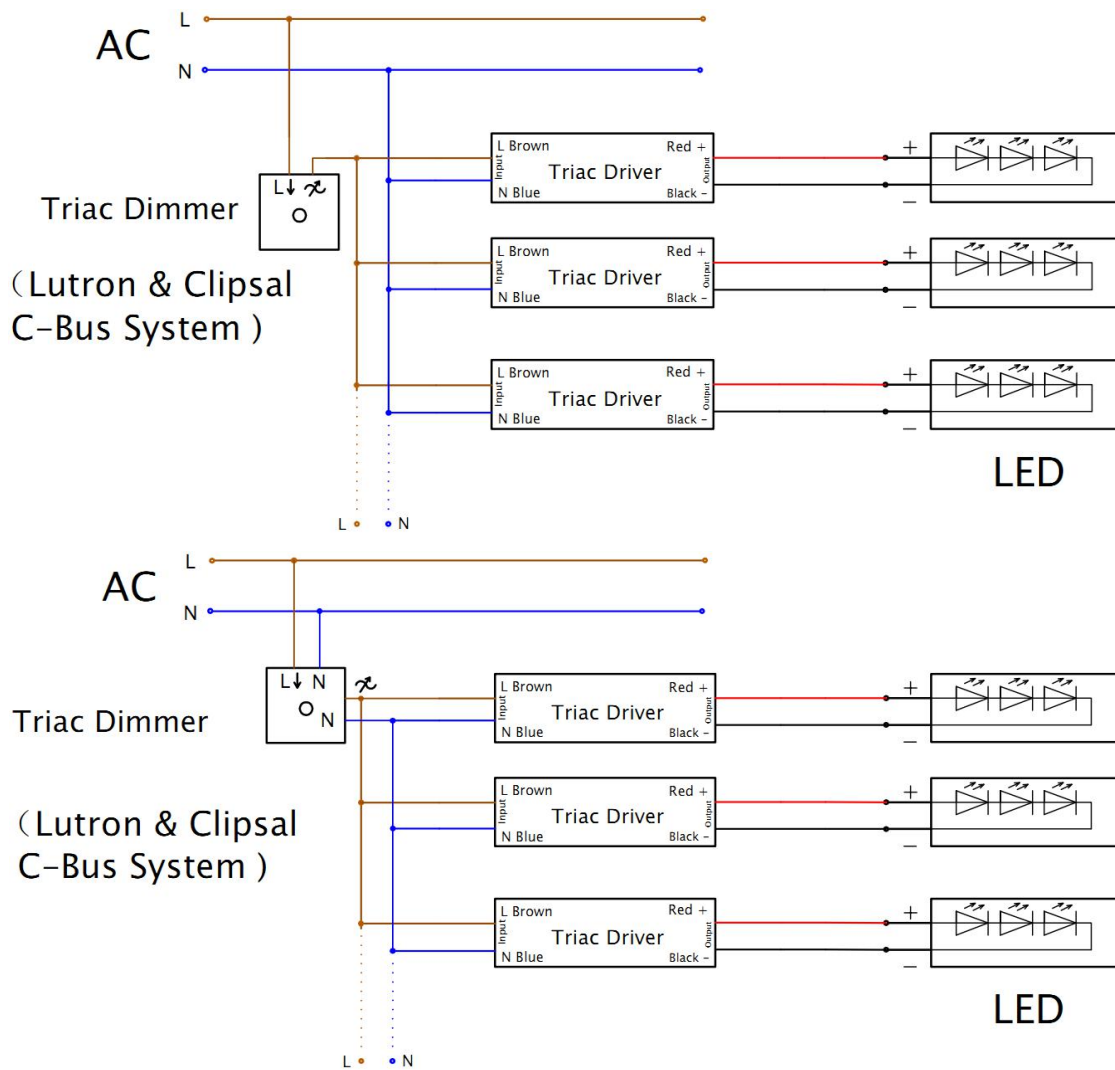

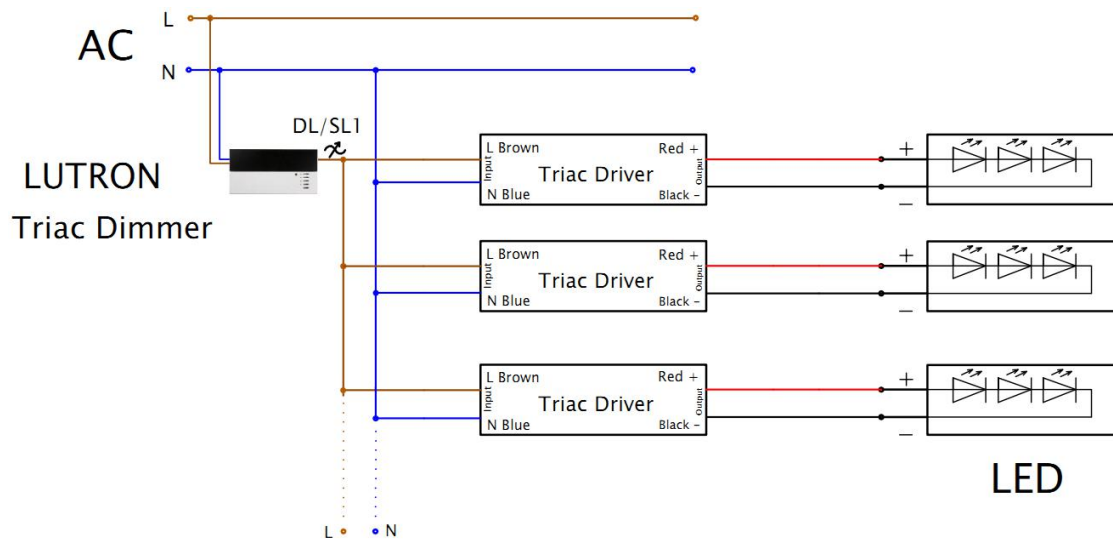

■ Instruction:

- This driver should be installed by qualified and professional person;
- Please make sure the driver is installed with adequate ventilation around it to allow for heat dissipation.
- Ensure that wiring is correct before test in order to avoid light and power supply damage;
- If the LED drivers does not work properly, contact us by email at info@prismlightinggroup.com, by phone 1-866-620-1380 to get technical support or visit our official Website: www.PrismLightingGroup.com