

M series LED controller M2

RF WIRELESS



RoHS FC CE (EMC, R&TTE)

2. Product Size:

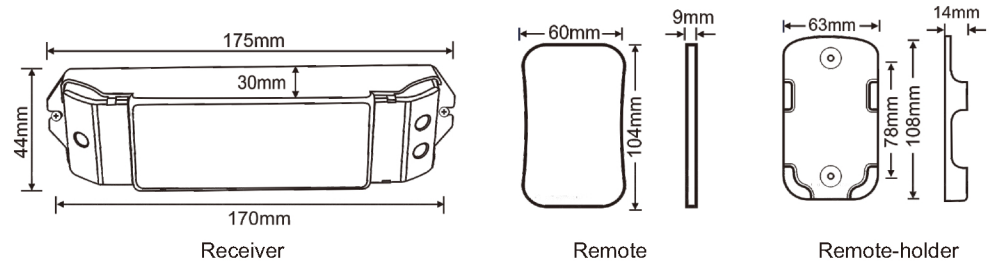

3. The Learning ID Method of Remote Control:

Remote control has been matched to the receiver before leave factory, if deleted accidentally, you can learn ID as follow.

Learning ID: Short press ID learning button on the M4-5A receiver, the running light is on, then press any key on the M2 remote control, the running light flashes several times, activated.

Cancel ID: Long press ID learning button on the M4-5A receiver for 5 seconds.

Attn: one receiver can be matched with max 10 same or different kinds remote.

4. Operating Instruction for Receiver :



5. Operating Instruction for Remote Control :

Sleep Mode:

the remote goes on a standby mode to save power when not in use for 30s. press any key to continue.

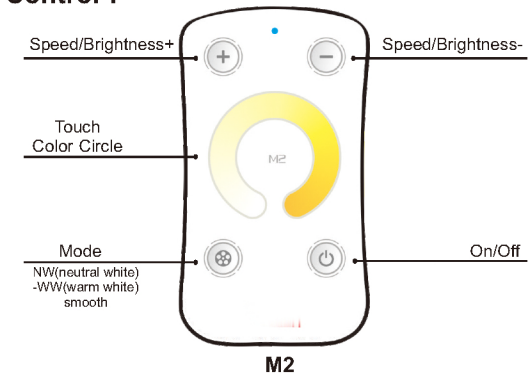

1. Parameter:

Remote(CT):

Model:	M2
Working Voltage:	3Vdc (battery CR2032)
Working Frequency:	433.92MHz
Remote Distance:	30m
Working Temp.:	-30°C~55°C
Weight(N.W.):	42g

CV Receiver (CT):

Model:	M4-5A
Input Voltage:	5~24Vdc
Current Load:	5A×4CH Max 20A
Max Output Power:	(0~25W...120W) × 4CH
Protection:	Short circuit / Over-load
Working Temp.:	-30°C~55°C
Weight(N.W.):	125g

6. Wiring Diagram:

E.g. 1: Connected 12V lamp, loads 0~240W(12V).

[Attn]: The receiver is 4 channels 2 groups socket output.

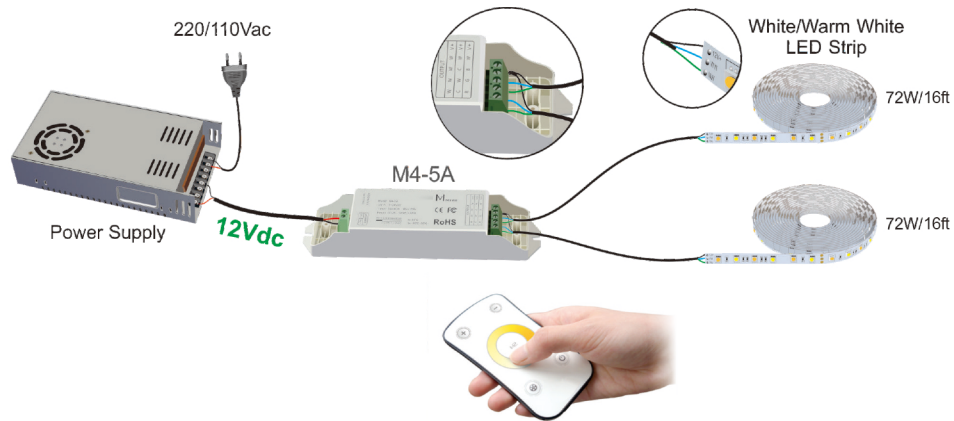

E.g. 2: Connected 24V lamp, loads 0~480W(24V).

[Attn]: The receiver is 4 channels 2 groups socket output.

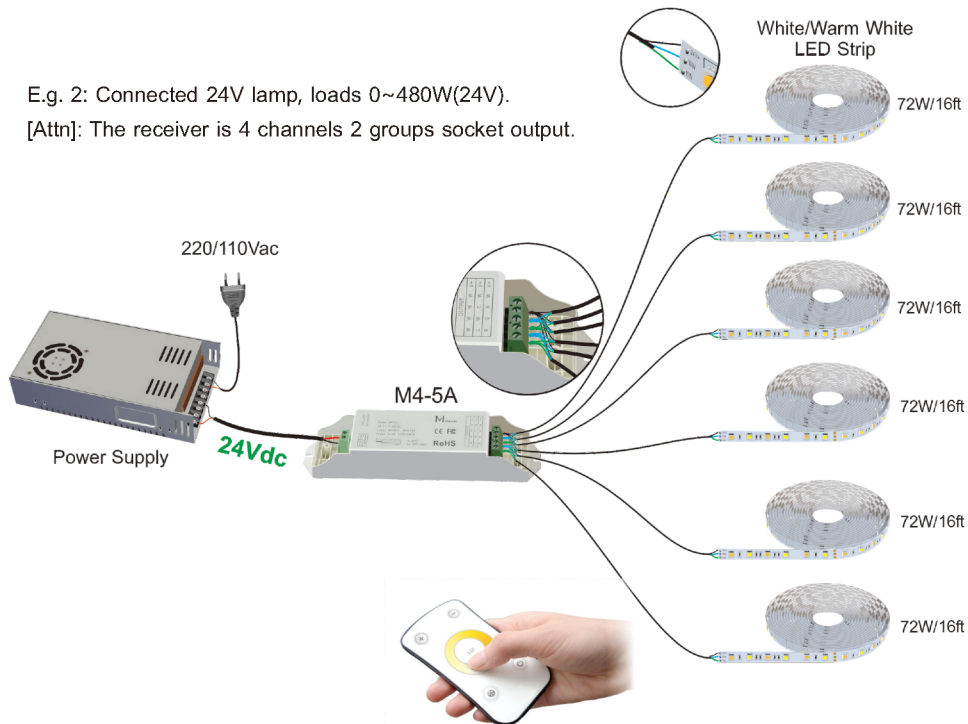

7. Attention:

- 7.1 The product shall be installed and serviced by a qualified person.
- 7.2 This product is non-waterproof. Please avoid the sun and rain. When installed outdoors please ensure it is mounted in a water proof enclosure.
- 7.3 Good heat dissipation will prolong the working life of the controller. Please ensure good ventilation.
- 7.4 Please check if the output voltage of any LED power supplies used comply with the working voltage of the product.
- 7.5 Please ensure that adequate sized cable is used from the controller to the LED lights to carry the current. Please also ensure that the cable is secured tightly in the connector.
- 7.6 Ensure all wire connections and polarities are correct before applying power to avoid any damages to the LED lights.
- 7.7 If a fault occurs please return the product to your supplier. Do not attempt to fix this product by yourself.